

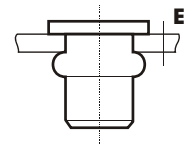

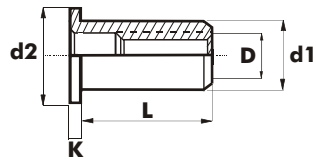



ALUMINIUM LARGE HEAD OPEN END





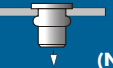

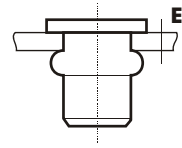
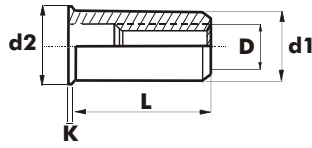

D	 MAX. E m/m	L m/m	d1 Ø m/m	d2 Ø m/m	K m/m		ART. N°
M 4	0,25 - 3,00	9,50	6,00	9,00	1,00	6,10	030210 4006
	3,00 - 5,50	15,00	7,00	10,00	1,00	7,10	030211 5007
M 5	0,50 - 3,00	12,00	7,00	10,00	1,00	7,10	030210 5007
	3,00 - 5,50	15,00	7,00	10,00	1,00	7,10	030211 5007
M 6	0,50 - 3,00	14,50	9,00	13,00	1,50	9,10	030210 6009
	3,00 - 5,50	16,50	9,00	13,00	1,50	9,10	030211 6009
M 8	0,50 - 3,00	16,50	11,00	15,00	1,50	11,10	030210 8011
	3,00 - 5,50	18,50	11,00	15,00	1,50	11,10	030211 8011

d1 Ø m/m	 (N)	 (N)	 (Nm)
M 4	2.201	5.000	2,0
M 5	2.780	7.600	5,5
M 6	5.124	9.000	9,0
M 8	5.425	11.700	16,9

ALUMINIUM REDUCED HEAD OPEN END





D	 MAX. E m/m	L	d1	d2		ART. N°
	m/m	m/m	∅ m/m	∅ m/m		
M 6	0,50 - 3,00	14,50	9,00	10,00	9,10	030220 6009

d1	 m/m	 (N)	 (N)	 (Nm)
M 6	4.171	8.100	8,0	

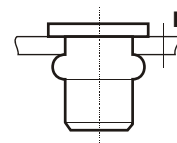
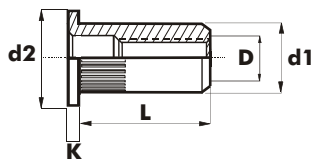

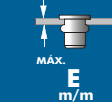
STAINLESS STEEL KNURLED LARGE HEAD OPEN END



D	 MAX. E m/m	L m/m	d1 Ø m/m	d2 Ø m/m	K m/m		ART. N°
M 4	0,25 - 2,00	10,00	6,00	9,00	1,00	6,10	037310 4006
M 5	0,50 - 3,00	12,00	7,00	10,00	1,00	7,10	037310 5007
M 6	0,50 - 3,00	14,50	9,00	13,00	1,50	9,10	037310 6009
M 8	0,50 - 3,00	16,00	11,00	16,00	1,50	11,10	037310 8011

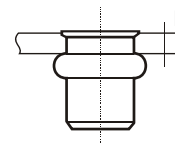
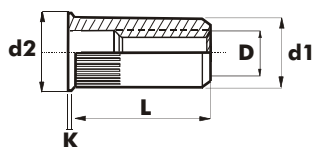

STAINLESS STEEL KNURLED REDUCED HEAD OPEN END



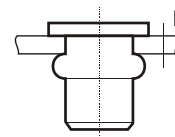
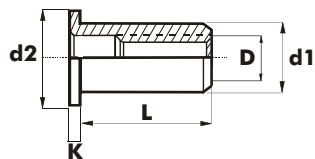

D	 MAX. E m/m	L m/m	d1 ∅ m/m	d2 ∅ m/m		ART. N°
M 4	0,50 - 2,00	11,00	6,00	7,00	6,10	037320 4006
M 5	0,50 - 3,00	12,00	7,00	8,00	7,10	037320 5007
M 6	0,50 - 3,00	14,50	9,00	10,00	9,10	037320 6009
M 8	0,50 - 3,00	16,00	11,00	12,00	11,10	037320 8011

STAINLESS STEEL LARGE HEAD OPEN END



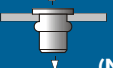

D	 MAX. E m/m	L m/m	d1 Ø m/m	d2 Ø m/m	K m/m		ART. N°
M 4	0,25 - 2,00	10,00	6,00	9,00	1,00	6,10	030310 4006
M 5	0,50 - 3,00	12,00	7,00	10,00	1,00	7,10	030310 5007
M 6	0,50 - 3,00	14,50	9,00	13,00	1,50	9,10	030310 6009
M 8	0,50 - 3,00	16,00	11,00	16,00	1,50	11,10	030310 8011

d1 Ø m/m	 (N)	 (N)	 (Nm)
M 4	3.246	5.500	3,1
M 5	3.460	8.900	6,9
M 6	6.141	10.650	12,1
M 8	8.708	12.600	19,3

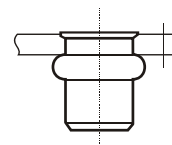
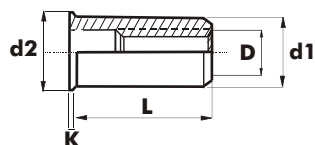
STAINLESS STEEL REDUCED HEAD OPEN END

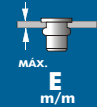

D	 E m/m	L m/m	d1 Ø m/m	d2 Ø m/m		ART. N°
M 4	0,50 - 2,00	11,00	6,00	7,00	6,10	030320 4006
M 5	0,50 - 3,00	12,00	7,00	8,00	7,10	030320 5007
M 6	0,50 - 3,00	14,50	9,00	10,00	9,10	030320 6009
M 8	0,50 - 3,00	16,00	11,00	12,00	11,10	030320 8011

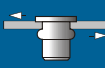
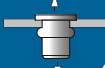
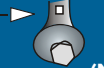

d1 Ø m/m	 (N)	 (N)	 (Nm)
M 4	2.385	6.000	2,2
M 5	3.012	8.100	3,2
M 6	5.158	10.120	5,8
M 8	6.815	14.000	15,6



STEEL LARGE HEAD CLOSED END

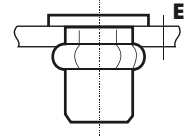
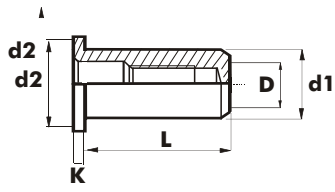

Chrome VI Free

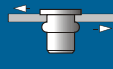

D	 MAX. E m/m	L m/m	d1 ∅ m/m	d2 ∅ m/m	K m/m		ART. N°
M 6	0,5 - 3,00	21,50	9,00	13,00	1,50	9,10	030140 6009

d1 ∅ m/m	 (N)	 (N)	 (Nm)
M 6	2.940	5.480	12,0



STEEL GROOVED COUNTERSUNK HEAD OPEN END

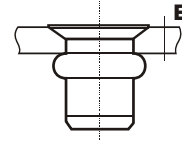
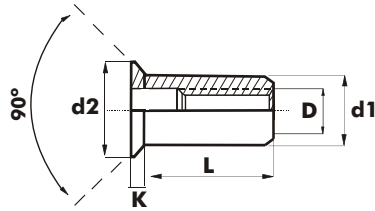

Chrome VI Free





D	 MAX. E m/m	L m/m	d1 Ø m/m	d2 Ø m/m	K m/m		ART. N°
M 4	1,00 - 3,00	11,50	6,00	9,00	1,50	6,10	037130 4006
M 5	1,50 - 4,00	13,00	7,00	10,00	1,50	7,10	037130 5007
M 6	1,50 - 4,00	16,00	9,00	12,00	1,50	9,10	037130 6009
M 8	1,50 - 4,00	19,00	11,00	14,00	1,50	11,10	037130 8011
M 10	1,50 - 4,50	22,00	13,00	15,70	1,50	13,10	037130 1013

d1 Ø m/m	 (N)	 (N)	 (Nm)
M 4	3.132	7.000	3,3
M 5	3.333	8.700	6,5
M 6	6.872	9.920	11,3
M 8	9.071	12.500	22,0

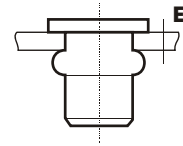
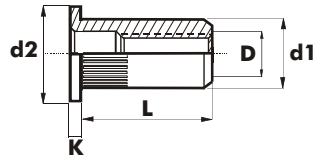
STEEL GROVED LARGE HEAD OPEN END



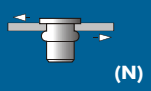
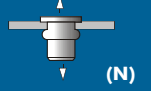

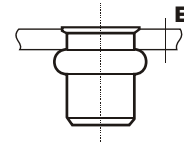
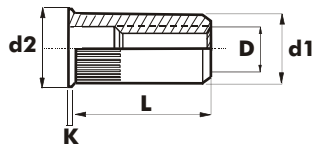

D	 MÁX. E m/m	L m/m	d1 Ø m/m	d2 Ø m/m	K m/m		ART. N°
M 3	0,25 - 2,00	9,75	5,00	7,50	1,00	5,10	037110 3005
	3,00 - 4,50	12,25	6,00	9,00	1,00	6,10	037111 4006
M 5	0,25 - 3,00	12,00	7,00	10,00	1,00	7,10	037110 5007
	3,00 - 5,50	15,00	7,00	10,00	1,00	7,10	037111 5007
M 6	0,50 - 3,00	14,50	9,00	13,00	1,50	9,10	037110 6009
	3,00 - 5,50	16,50	9,00	13,00	1,50	9,10	037111 6009
M 8	0,50 - 3,00	16,50	11,00	16,00	1,50	11,10	037110 8011
	3,00 - 5,50	18,50	11,00	16,00	1,50	11,10	037111 8011
M 10	0,50 - 3,50	19,50	13,00	19,00	2,00	13,10	037110 1013
	3,50 - 6,00	21,50	13,00	19,00	2,00	13,10	037111 1013
M 12	1,00 - 4,00	25,00	16,00	23,00	2,00	16,10	037110 1216

d1 Ø m/m	 (N)	 (N)	 (Nm)
M 3	1.535	2.600	2,2
M 4	3.282	5.900	4,5
M 5	4.649	8.900	5,8
M 6	6.562	11.320	18,0
M 8	9.450	12.100	34,5
M 10	10.715	15.000	60,0
M 12	12.728	28.200	70,0

STEEL GROOVED REDUCED HEAD OPEN END

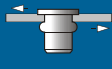

D	 MAX. E m/m	L m/m	d1 Ø m/m	d2 Ø m/m		ART. N°
M 4	0,50 - 2,00	10,40	6,00	7,00	6,10	037120 4006
M 5	0,50 - 3,00	11,50	7,00	8,00	7,10	037120 5007
M 6	0,50 - 3,00 3,00 - 5,50	14,50 16,50	9,00 9,00	10,00 10,00	9,10 9,10	037120 6009 037121 6009
M 8	0,80 - 4,50	16,80	11,00	12,00	11,10	037120 8011
M 10	0,70 - 3,50	20,80	13,00	14,00	13,10	037120 1013

d1 Ø m/m	 (N)	 (N)	 (Nm)
M 4	2.786	5.950	2,9
M 5	3.942	8.340	6,0
M 6	5.675	9.960	10,5
M 8	8.525	10.600	15,5
M 10	9.320	14.200	18,0

STEEL REDUCED HEAD OPEN END

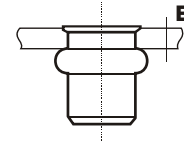
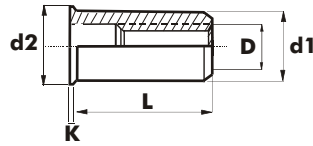

D	MAX. E m/m	L m/m	d1 Ø m/m	d2 Ø m/m		ART. N°
M 3	0,50 - 1,50	8,70	4,92	5,40	4,75	030120 3004
M 4	0,50 - 2,00	10,40	6,30	6,70	6,40	030120 4006
M 5	0,50 - 3,00	11,50	7,10	7,90	7,20	030120 5007
M 6	0,70 - 3,00	14,50	9,50	10,20	9,60	030120 6009
M 8	0,80 - 4,50	16,00	10,50	11,30	10,60	030120 8011

d1 Ø m/m	(N)	(N)	(Nm)
M 3	811	2.200	1,7
M 4	1.742	7.000	2,8
M 5	3.389	7.800	5,7
M 6	5.146	11.000	6,5
M 8	8.284	12.400	8,6